

CODIGO	DESCRIPCION
MINISWITCHES SERIE 2P1 Y 2P2	Miniswitches serie 2P1 y 2P2

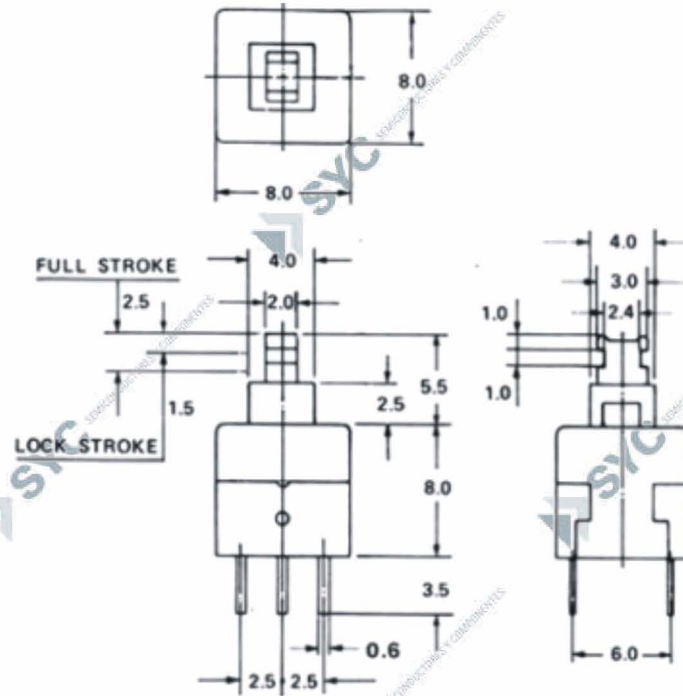

■ CHARACTERISTICS

- Operating force 150gf (Different force on request)
- Travel Pre-travel 1.5±0.2 mm
Full-travel 2.5±0.5 mm
- Contact resistance (initial) 100 mΩ Max.
- Insulation resistance (at 500VDC) 100 MΩ Min.
- Insulation breakdown voltage 125 V AC for one minute.
- Life cycling (no load) 100,000 cycles (Min) at a rate 10 cycles per minute
- Life cycling (full load) 10,000 cycles (Min) at a rate 10 cycles per minute
- Ambient temperature -25°C to +65°C

■ OPERATING FORCE

	NON LOCK	LOCK
L:	90±30g	130±50g
S:	150±50g	180±50g

■ APPLICATION

Telephone, computer, instrument, tester.

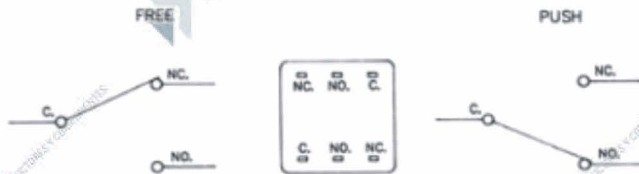

TOP BUTTON. DIMENSIONS
 1: 7x7x8mm 3: φ7x8mm

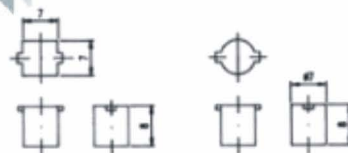

■ ORDERING INFORMATION

SERIES PREFIX	C O D E	T Y P E	C O D E	O P E R A T I N G F O R C E	C O D E	T O P B U T T O N T Y P E	C O D E	T O P B U T T O N C O L O R		
P	1	NON LOCK	S	LIGHT	1	7x7x8mm	R	RED	W	WHITE
P	1	LOCK	S	STANDARD	3	φ7x8mm	L	BLUE	E	GREEN
	2	NON LOCK CLICK					B	BLACK	Y	YELLOW

CODIGO	DESCRIPCION
MINISWITCHES SERIE 2P1 Y 2P2	Miniswitches serie 2P1 y 2P2

■ CONTACT CONFIGURATION

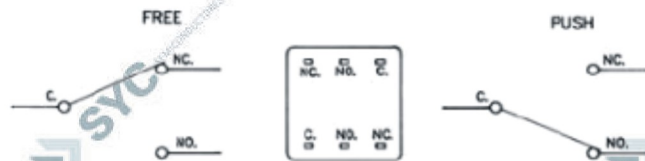

■ CHARACTERISTICS

- Operating force 150gf (Different force on request)
- Travel Pre-travel 1.5±0.2 mm
Full-travel 2.5±0.5 mm
- Contact resistance (initial) 100 mΩ Max.
- Insulation resistance 100 MΩ Min. (at 500VDC)
- Insulation breakdown voltage 125 VAC for one minute
- Bounce 5m Sec. Max.
- Life cycling (no load) 100,000 cycles (Min) at a rate 10 cycles per minute.
- (full load) 10,000 cycles (Min) at a rate 10 cycles per minute.
- Ambient temperature -25°C to +65°C

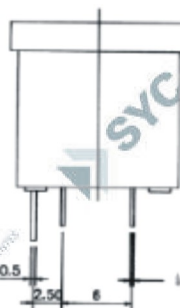
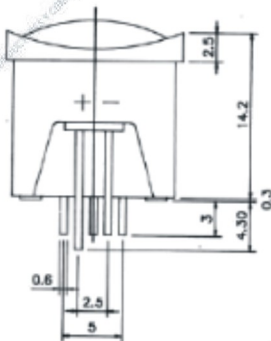
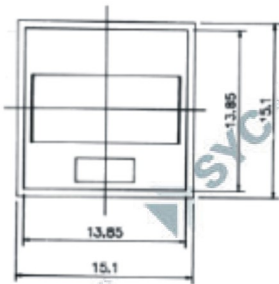

■ CONTACT CONFIGURATION



■ CHARACTERISTICS

- Operating force 150gf (Different force on request)
- Travel Pre-travel 1.5±0.2 mm
Full-travel 2.5±0.5 mm
- Contact resistance (initial) 100 mΩ Max.
- Insulation resistance 100 MΩ Min. (at 500VDC)
- Insulation breakdown voltage 125 VAC for one minute
- Bounce 5m Sec. Max.
- Life cycling (no load) 100,000 cycles (Min) at a rate 10 cycles per minute.
- (full load) 10,000 cycles (Min) at a rate 10 cycles per minute.
- Ambient temperature -25°C to +65°C

CODIGO	DESCRIPCION
MINISWITCHES SERIE 2P1 Y 2P2	Miniswitches serie 2P1 y 2P2

■ EXPLODE DRAWING

No.	DESCRIPTION
1	CASE BLACK OR GRAY
2	LED RED OR GREEN
3	TOP BUTTON BROWN ORANGE BLUE RED YELLOW GREEN
4	P1-0S, P1-1S NO LOCK, LOCK
5	HOLDER (BLACK)



■ TOP BUTTON (DIMENSIONS)

■ DIMENSIONS (Unless otherwise specified, a tolerance of $\pm 0.4\text{mm}$ applies to all dimensions.)

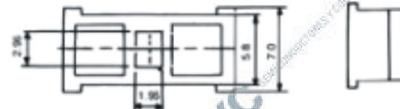
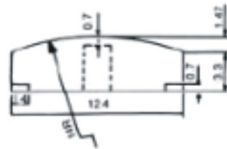

■ EXPLODE DRAWING

No.	DESCRIPTION
1	CASE BLACK OR GRAY
2	LED RED OR GREEN
3	TOP BUTTON BROWN ORANGE BLUE RED YELLOW GREEN
4	P1-0S, P1-1S NO LOCK, LOCK
5	HOLDER (BLACK)



■ TOP BUTTON (DIMENSIONS)

■ DIMENSIONS (Unless otherwise specified, a tolerance of $\pm 0.4\text{mm}$ applies to all dimensions)

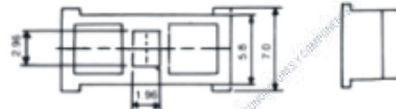
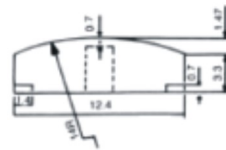

■ APPLICATION

Computer, alarm, coin-op phone, auto door roller.

■ ORDERING INFORMATION

P	2	0	S	L	G	R
SERIES PREFIX	CODE TYPE	CODE OPERATING FORCE	CODE TOP BUTTON TYPE	CODE CASE COLOR	CODE LED COLOR	
	0 NON LOCK	NON LOCK 150±50g	R RED	G GRAY	R RED	
	1 LOCK	LOCK 180±50g	L BLUE	B BLACK	E GREEN	
	2 NON LOCK CLICK		E GREEN		Y YELLOW	
			Y YELLOW		WITHOUT LED	
			N BROWN			
			O ORANGE			