

1

2

3

4

5

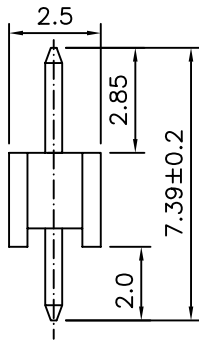
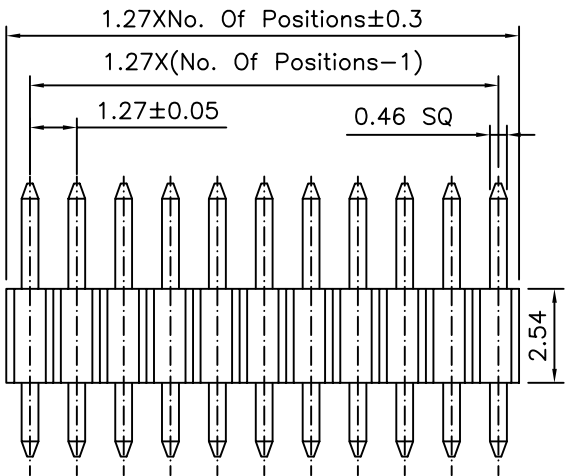
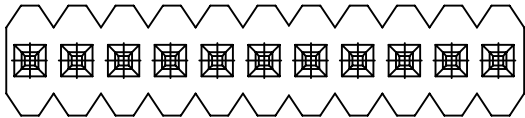

Specifications:

Current Rating:1.0A AC/DC
 Voltage Rating:50V AC/DC
 Contact Resistance:20m ohm. max.
 Insulation Resistance:500M ohm. min.
 Withstanding Voltage:500V AC For One Minute
 Operating Temperature Range:-25°C ~ +105°C
 Material and Finish
 Insulator:High Temp. Plastic(PBT UL94V-0)
 Insulator Color:Black
 Contact:Copper Alloy
 Plated:Gold Plated

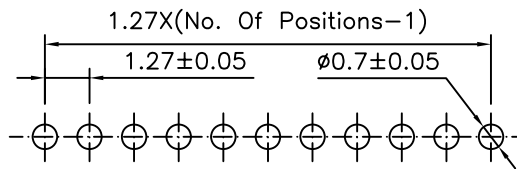

Recommended P.C.B. Layout

RoHS Compliant



www.sycelectronica.com.ar

GENERAL TOLERANCE: .X=±0.2 .XX=±0.15	MACHO .05" 40V RECTO	
UNIT: MM	DESCRIPTION:	SIZE
SCALE:	1.27mm Pin Header Straight Single Row	A4
SHEET: 1 / 1	PART NO:	
PROJECTION:	PLS40-1.27MM	

A

B

C

D