

Specifications:

- Current Rating:13.5A AC/DC
- Voltage Rating:600V AC/DC
- Contact Resistance:3.5m ohm. max.
- Withstanding Voltage:1,500V AC/minute
- Operating Temperature Range:-55°C~+105°C
- Application Wires:AWG16 to 22
- Mates With 9635R Series Housing
- Material and Finish
- Contact:Brass
- Finish:Tin Plated
- Packing:See Table

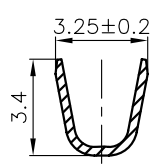
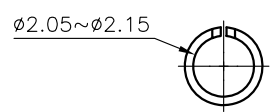

A-A

9635TS-1822-LF

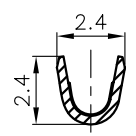

B-B

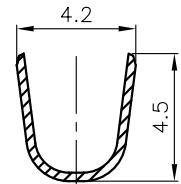

A-A

9635TS-1620-LF

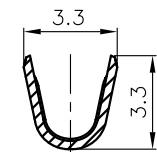

B-B

RoHS Compliant

GENERAL TOLERANCE: .X=±0.2 .XX=±0.15			
UNIT: MM	DESCRIPTION:	6.35mm Power Receptacle Terminal	
SCALE: 1:1	PART NO:		
SHEET: 1/1	9635TS-XXXX		A4
PROJECTION:			