

Specifications:

Current rating:1.0A AC/DC  
 Voltage rating:100V AC/DC  
 Contact resistance:15m ohm. max.  
 Insulator resistance:5000M ohm. Min.  
 Withstanding voltage:1000V AC for one minute  
 Operating temperature range:-40°C to +105°C  
 Material and Finish:  
 Insulator:PBT (UL94V-0)  
 Standard Color:Black  
 Contact:Beryllium Copper(Becu) Gold Plated  
 Sleeve Barrel:Copper Alloy Gold Plated

Note1: W/O middle bar(6~16P)  
 With middle bar(18~64P)

Circuits	DIM.A	DIM.B	DIM.C	DIM.D	Space	Circuits	DIM.A	DIM.B	DIM.C	DIM.D	Space
6	7.62	5.08	10.16	7.62	03	22	27.94	25.40	12.70	10.16	06
8	10.16	7.62	10.16	7.62		24	30.48	27.94	17.78	15.24	
14	17.78	15.24	10.16	7.62		28	35.56	33.02	17.78	15.24	
16	20.32	17.78	10.16	7.62		32	40.64	38.10	17.78	15.24	
18	22.86	20.32	10.16	7.62		40	50.80	48.26	17.78	15.24	
20	25.40	22.86	10.16	7.62		42	53.34	50.80	17.78	15.24	
24	30.48	27.94	10.16	7.62		48	60.96	58.42	17.78	15.24	
28	35.56	33.02	10.16	7.62		64	81.28	78.74	26.00	22.86	

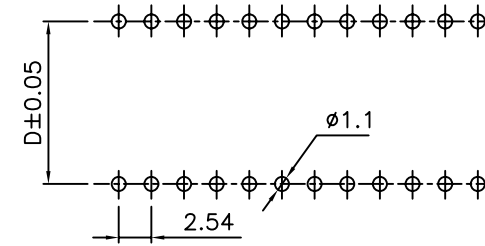

PCB LAYOUT

RoHS Compliant

GENERAL TOLERANCE: .X=±0.2 .XX=±0.15		DESCRIPTION: Screw Machine Pin IC Socket Wire Wrap Type	SIZE <b>A4</b>
UNIT: MM			
SCALE:		PART NO:	
SHEET: 1 / 1		<b>SCSXX-WW</b>	<b>A</b>
PROJECTION:			