

1

2

3

4

5

CIRCUITS	DIM. A	DIM. B	DIM. C	SPACE
6	7.62	7.62	10.16	03
8	10.16	7.62	10.16	
14	17.78	7.62	10.16	
16	20.32	7.62	10.16	
24	30.48	15.24	17.78	06
28	35.56	15.24	17.78	
32	40.64	15.24	17.78	
40	50.80	15.24	17.78	

### MATERIAL & FINISH

\* Contact: Beryllium Copper (BeCu)

\* Sleeve: Brass

Plating: G=Gold Plated

T=Tin Plated

\* Insulator: IC Socket=PBT (UL94V-0)

\* Insertion Standard Force: 300g max.

\* Extraction Standard Test: 60g min.

\* PBT Heat resisting durability: Max. 160~180°C, 5 Sec.

\* Current Rating: 1A

\* Operating Humidity Range: Annual mean 75%

\* Contact Resistance : 10 Milliohm

\* Insulator Resistance : 5000 Mege Ohm at 500 VDC

\* Dielectric Strength : 1000 VRMS Min

\* Rated Voltage : 100 VRMS / 150VDC

\* Temperature: - 55°C TO + 125°C

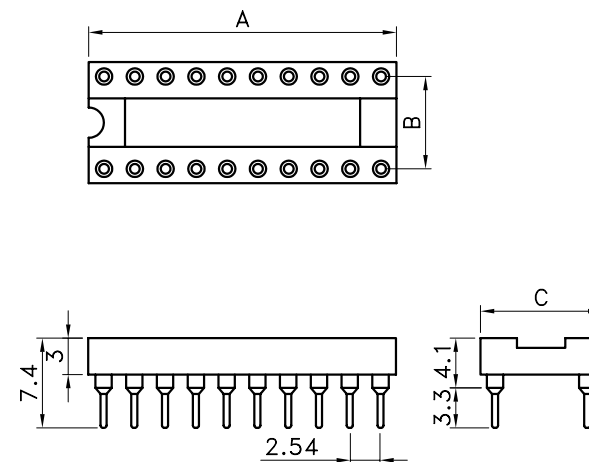
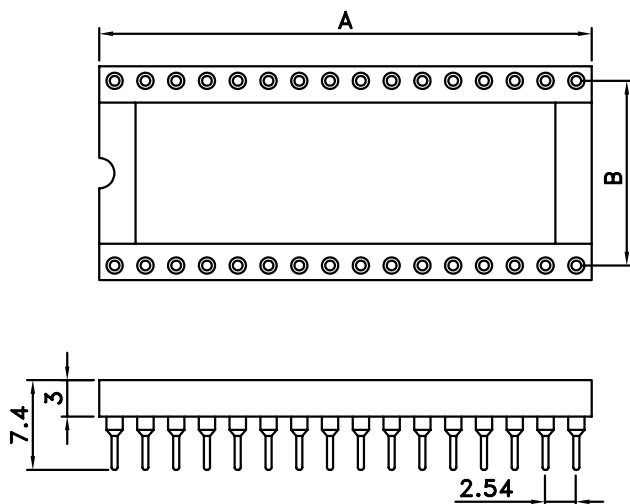

F				DRAWN:	GENERAL TOLERANCE:		
E				J	.X=±0.2		
D				CHECKED:	.XX=±0.15		
C					UNIT: MM	DESCRIPTION:	SIZE
					SCALE:	SCREW MACHINE PIN IC SOCKET	A4
G				APPROVAL:	SHEET: 1 / 1	PART NO:	
REV	DATE	FILE	BY		PROJECTION:	SCSXX-T	