

CODIGO

PLS-20X-XX

DESCRIPCION

Conector tipo industrial serie PLS de X vias

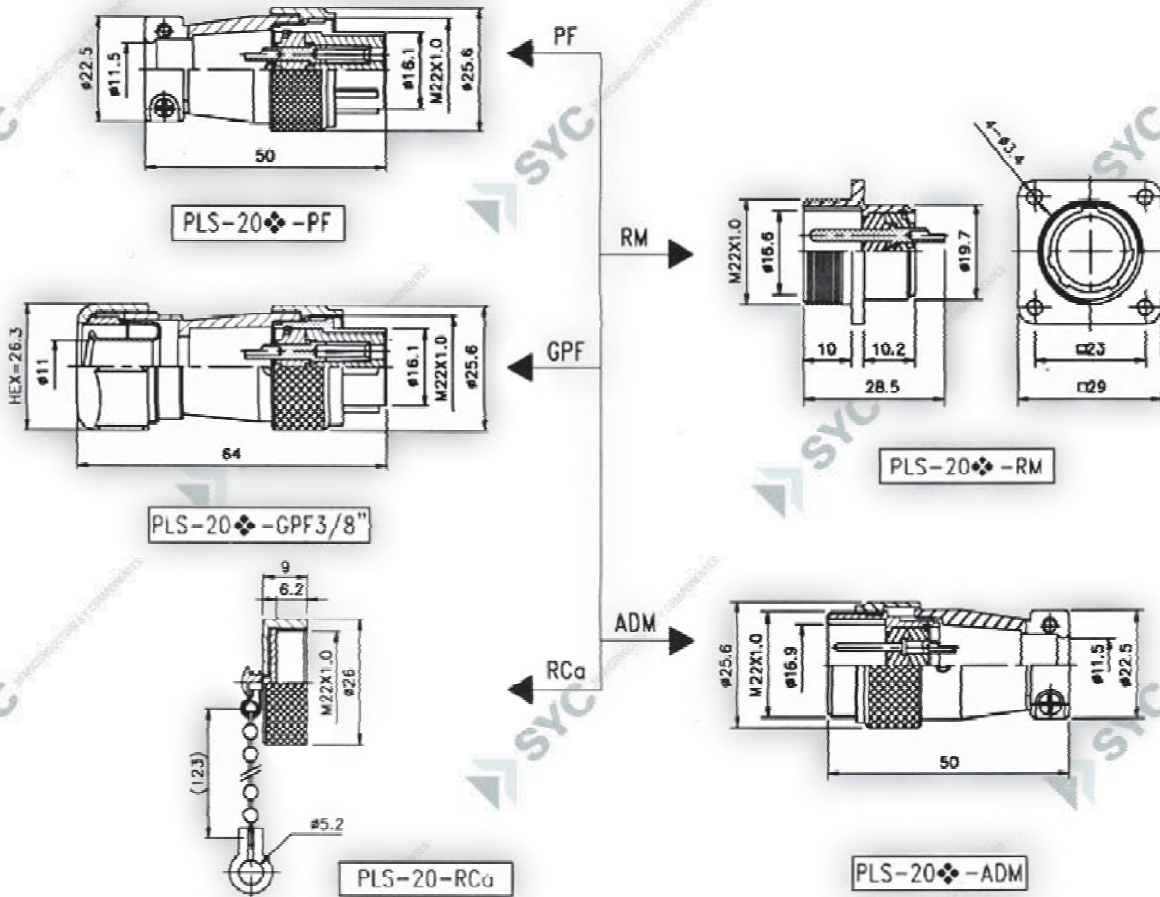



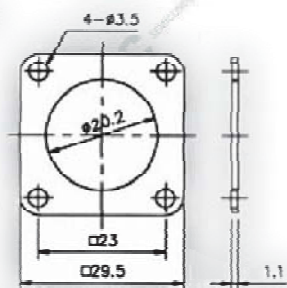

ACCESSORY:

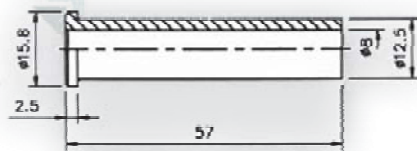

RUBBER PLATE FOR PLS-20-RM



RUBBER TUBE FOR PLS-20-PF

◆ No. of contacts	2	3	4	7				
Contacts Configuration								
Rated current/voltage	15A 250V	15A 250V	10A 250V	10A 250V				
Operation limit voltage (AC.V.rms)	250	250	250	250				
Withstanding voltage (AC.V.rms) 1 minute	1500	1500	1500	1000				
Insulation resistance (MΩ MIN.) at DC 500V	2000	2000	2000	2000				
Contact resistance (mΩ MAX.) at DC 1A	3	3	3	3				
Pin diameter (Ømm)	1.8	1.8	1.6	1.6				

CODIGO	DESCRIPCION
PLS-20X-XX	Conector tipo industrial serie PLS de X vias

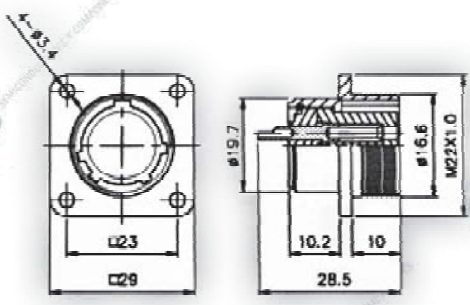

PLS-20-RF

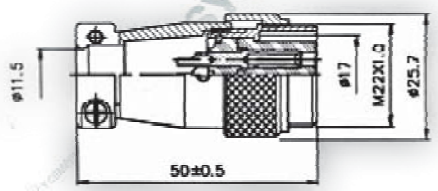

PLS-20-ADF

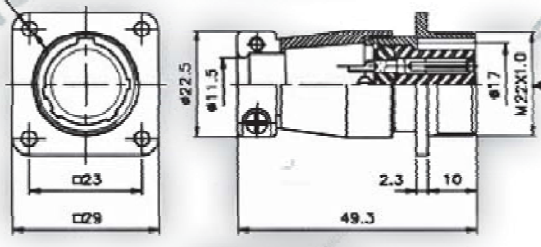

PLS-20-AD(F)

ACCESSORY:

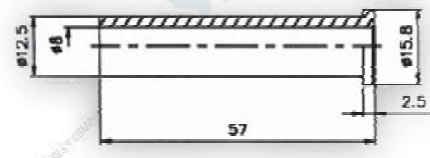

RUBBER TUBE FOR PLS-20-PM

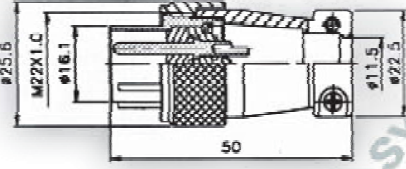

PLS-20-PM

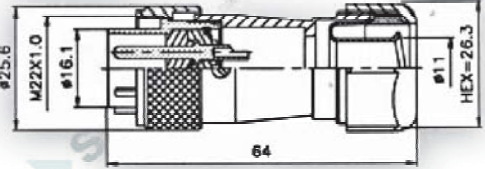



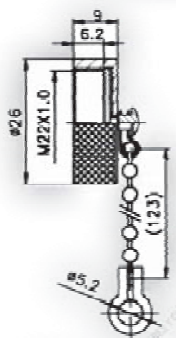

PLS-20-GPM3/8"

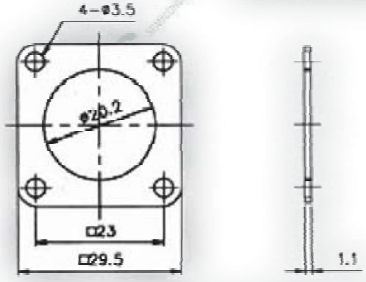

PLS-20-RCa



RUBBER PLATE FOR PLS-20-RF

◆ No. of contacts	2	3	4	7						
Contacts Configuration										
Rated current/voltage	15A 250V	15A 250V	10A 250V	10A 250V						
Operation limit voltage (AC.V.rms)	250	250	250	250						
Withstanding voltage (AC.V.rms) 1 minute	1500	1500	1500	1000						
Insulation resistance (MΩ MIN.) at DC 500V	2000	2000	2000	2000						
Contact resistance (mΩ MAX.) at DC 1A	3	3	3	3						
Pin diameter (φmm)	1.8	1.8	1.6	1.6						